

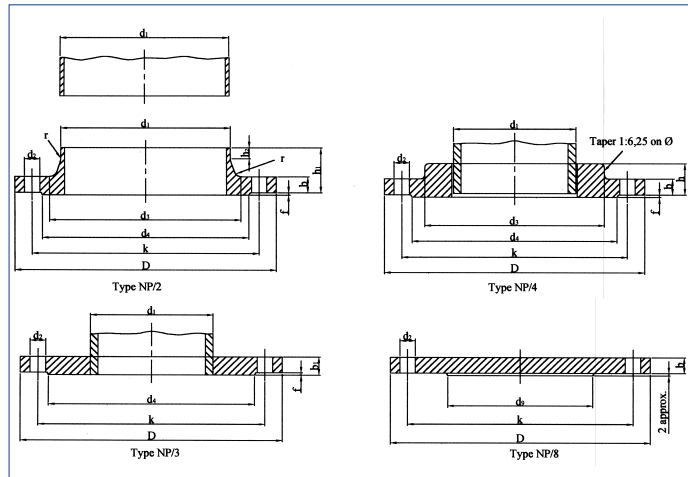

STAINLESS STEEL FLANGES

BS 4504 Flanges



NP = Nominal Pressure 6, 10, 16, 25, 40

Nominal pressure 6 bar (1 bar = 10 ⁵ N/m ²)																	Description	
Nom. Size	Pipe O.D d ₁	Flange					Raised face			Bolting	Drilling			Neck			Spigot d ₉	Boss d ₃
		D	b	b ₁	h	h ₁	d ₄	f	No.		d ₂	k	d ₃	h ₂	r			
10	17.2	75	12	12	20	28	35	2	M10	4	11	50	26	6	4	-	25	
15	21.3	80	12	12	20	30	40	2	M10	4	11	55	30	6	4	-	30	
20	26.9	90	14	14	24	32	50	2	M10	4	11	65	38	6	4	-	40	
25	33.7	100	14	14	24	35	60	2	M10	4	11	75	42	6	4	-	50	
32	42.4	120	14	16	26	35	70	2	M12	4	14	90	55	6	6	-	60	
40	48.3	130	14	16	26	38	80	3	M12	4	14	100	62	7	6	-	70	
50	60.3	140	14	16	28	38	90	3	M12	4	14	110	74	8	6	-	80	
65	76.1	160	14	16	32	38	110	3	M12	4	14	130	88	9	6	55	100	
80	88.9	190	16	18	34	42	128	3	M16	4	18	150	102	10	8	70	110	
100	114.3	210	16	18	40	45	148	3	M16	4	18	170	130	10	8	90	130	
125	139.7	240	18	20	44	48	178	3	M16	8	18	200	155	10	8	115	160	
150	168.3	265	18	20	44	48	202	3	M16	8	18	225	184	12	10	140	185	
200	219.1	320	20	22	44	55	258	3	M16	8	18	280	236	15	10	190	-	
250	273.0	375	22	24	44	60	312	3	M16	12	18	335	290	15	12	237	-	
300	323.9	440	22	24	44	62	365	4	M20	12	22	395	342	15	12	285	-	
350	355.6	490	22	26	-	62	415	4	M20	12	22	445	385	15	12	332	-	
400	406.4	540	22	28	-	65	465	4	M20	16	22	495	438	15	12	380	-	
450	457.2	595	24	30	-	65	520	4	M20	16	22	550	492	15	12	428	-	
500	508.0	645	24	30	-	68	570	4	M20	20	22	600	538	15	12	475	-	
600	609.6	755	24	32	-	70	670	5	M24	20	26	705	640	16	12	-	-	



BS 4504 Flanges *cont'd...*

Nominal pressure 10 bar (1 bar = 10 ⁵ N/m ²)																	
Note: For nominal sizes 10 to 175 use Table 16																Description	
Nom. Size	Pipe O.D d ₁	Flange					Raised face		Bolting	Drilling			Neck			Spigot d ₉	Boss d ₃
		D	b	b ₁	h	h ₁	d ₄	f		No.	d ₂	k	d ₃	h ₂ ≈	r		
200	219.1	340	24	24	44	62	268	3	M20	8	22	295	235	16	10	190	-
250	273.0	395	26	26	46	68	320	3	M20	12	22	350	292	16	12	237	-
300	323.9	445	26	26	46	68	370	4	M20	12	22	400	344	16	12	285	-
350	355.6	505	26	28	-	68	430	4	M20	16	22	460	385	16	12	332	-
400	406.4	565	26	32	-	72	482	4	M24	16	26	515	440	16	12	380	-
450	457.2	615	28	36	-	72	532	4	M24	20	26	565	492	16	12	428	-
500	508.0	670	28	38	-	75	585	4	M24	20	26	620	542	16	12	-	-
600	609.6	780	28	42	-	80	685	5	M27	20	30	725	642	18	12	-	-

Nominal pressure 16 bar (1 bar = 10 ⁵ N/m ²)																	
																Description	
Nom. Size	Pipe O.D d ₁	Flange					Raised face		Bolting	Drilling			Neck			Spigot d ₉	Boss d ₃
		D	b	b ₁	h	h ₁	d ₄	f		No.	d ₂	k	d ₃	h ₂ ≈	r		
10	17.2	90	14	14	20	35	40	2	M12	4	14	60	28	6	4	-	30
15	21.3	95	14	14	20	35	45	2	M12	4	14	65	32	6	4	-	35
20	26.9	105	16	16	24	38	58	2	M12	4	14	75	40	6	4	-	45
25	33.7	115	16	16	24	38	68	2	M12	4	14	85	46	6	4	-	52
32	42.4	140	16	16	26	40	78	2	M16	4	18	100	56	6	6	-	60
40	48.3	150	16	16	26	42	88	3	M16	4	18	110	64	7	6	-	70
50	60.3	165	18	18	28	45	102	3	M16	4	18	125	75	8	6	-	85
65	76.1	185	18	18	32	45	122	3	M16	4	18	145	90	10	6	55	105
80	88.9	200	20	20	34	50	138	3	M16	8	18	160	105	10	8	70	118
100	114.3	220	20	20	40	52	158	3	M16	8	18	180	131	12	8	90	140
125	139.7	250	22	22	44	55	188	3	M16	8	18	210	156	12	8	115	168
150	168.3	285	22	22	44	55	212	3	M20	8	22	240	184	12	10	140	195
175	193.7	315	24	24	-	60	242	3	M20	8	22	270	210	12	10	165	-
200	219.1	340	24	24	44	62	268	3	M20	12	22	295	235	16	10	190	-
250	273.0	405	26	26	46	70	320	3	M24	12	26	355	292	16	12	237	-
300	323.9	460	28	28	46	78	378	4	M24	12	26	410	344	16	12	285	-
350	355.6	520	30	32	-	82	438	4	M24	16	26	470	390	16	12	332	-
400	406.4	580	32	36	-	85	490	4	M27	16	30	525	445	16	12	380	-
450	457.2	640	34	40	-	87	550	4	M27	20	30	585	496	16	12	428	-
500	508.0	715	34	44	-	90	610	4	M30	20	33	650	548	16	12	475	-
600	609.6	840	36	52	-	95	725	5	M33	20	36	770	652	18	12	-	-



BS 4504 Flanges *cont'd...*

Nominal pressure 25 bar (1 bar = 10 ⁵ N/m ²)																	
Note: For nominal sizes 10 mm to 150 mm use Table 40																Description	
Nom. Size	Pipe O.D d ₁	Flange					Raised face		Bolting	Drilling			Neck			Spigot d ₉	Boss d ₃
		D	b	b ₁	h	h ₁	d ₄	f		No.	d ₂	k	d ₃	h ₂ ≈	r		
175	193.7	330	28	26	-	75	248	3	M24	12	26	280	218	15	10	165	-
200	219.1	360	30	28	52	80	278	3	M24	12	26	310	244	16	10	190	-
250	273.0	425	32	32	60	88	335	3	M27	12	30	370	298	18	12	237	-
300	323.9	485	34	38	67	92	395	4	M27	16	30	430	352	18	12	285	-
350	355.6	555	38	42	-	100	450	4	M30	16	33	490	398	20	12	332	-
400	406.4	620	40	46	-	110	505	4	M33	16	36	550	452	20	12	380	-
450	457.2	670	42	52	-	110	555	4	M33	20	36	600	505	20	12	425	-
500	508.0	730	44	58	-	125	615	4	M33	20	36	660	558	20	12	475	-
600	609.6	845	46	66	-	125	720	5	M36	20	39	770	660	20	12	-	-

Nominal pressure 40 bar (1 bar = 10 ⁵ N/m ²)																	
Description																Description	
Nom. Size	Pipe O.D d ₁	Flange					Raised face		Bolting	Drilling			Neck			Spigot d ₉	Boss d ₃
		D	b	b ₁	h	h ₁	d ₄	f		No.	d ₂	k	d ₃	h ₂ ≈	r		
10	17.2	90	16	16	22	35	40	2	M12	4	14	60	28	6	4	-	30
15	21.3	95	16	16	22	38	45	2	M12	4	14	65	32	6	4	-	35
20	26.9	105	18	18	26	40	58	2	M12	4	14	75	40	6	4	-	45
25	33.7	115	18	18	28	40	68	2	M12	4	14	85	46	6	4	-	52
32	42.4	140	18	18	30	42	78	2	M16	4	18	100	55	6	6	-	60
40	48.3	150	18	20	32	45	88	3	M16	4	18	110	64	7	6	-	70
50	60.3	165	20	20	34	48	102	3	M16	4	18	125	75	8	6	-	85
65	76.1	185	22	22	38	52	122	3	M16	8	18	145	90	10	6	55	105
80	88.9	200	24	24	40	58	138	3	M16	8	18	160	105	12	8	70	118
100	114.3	235	24	26	44	65	162	3	M20	8	22	190	134	12	8	90	145
125	139.7	270	26	28	48	68	188	3	M24	8	26	220	162	12	8	115	170
150	168.3	300	28	30	52	75	218	3	M24	8	26	250	192	12	10	140	200
175	193.7	350	32	32	-	82	260	3	M27	12	30	295	218	15	10	165	-
200	219.1	375	34	34	52	88	285	3	M27	12	30	320	244	16	10	190	-
250	273.0	450	38	42	60	105	345	3	M30	12	33	385	306	18	12	237	-
300	323.9	515	42	50	67	115	410	4	M30	16	33	450	362	18	12	285	-
350	355.6	580	46	56	-	125	465	4	M33	16	36	510	408	20	12	332	-
400	406.4	660	50	64	-	135	535	4	M36	16	39	585	462	20	12	380	-
500	508.0	755	52	72	-	140	615	4	M39	20	42	670	562	20	12	475	-



STAINLESS STEEL FLANGES

S.A.B.S 1123 Flanges

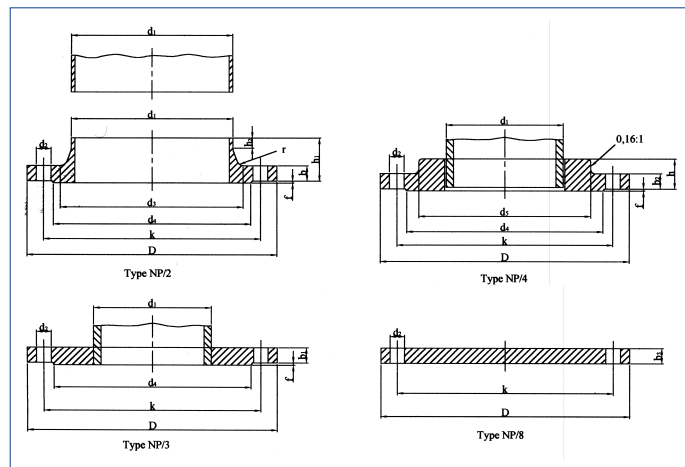

NP = Nominal Pressure 600kPa, 1000kPa, 1600kPa, 2500kPa, 4000kPa

Nominal pressure 600 kPa		600/2 = Table 4 600/3 = Table 5										600/4 = Table 6 600/8 = Table 8						
Nom. Size	Pipe O.D d ₁	Flange							Raised face		Bolting	Drilling			Neck			Boss d ₅
		D	b	b ₁	b ₂	b ₃	h	h ₁	d ₄	f		No.	d ₂	k	d ₃	h ₂	r	
10	17.2	75	8	10	8	10	16	28	35	2	M10	4	11	50	26	6	4	25
15	21.3	80	8	10	8	10	16	30	40	2	M10	4	11	55	30	6	4	30
20	26.9	90	8	10	8	10	18	32	50	2	M10	4	11	65	38	6	4	40
25	33.7	100	8	10	8	10	18	35	60	2	M10	4	11	75	42	6	4	50
32	42.4	120	8	10	8	10	20	35	70	2	M12	4	14	90	55	6	6	60
40	48.3	130	8	10	8	10	20	38	80	3	M12	4	14	100	62	7	6	70
50	60.3	140	8	10	8	10	22	38	90	3	M12	4	14	110	74	8	6	80
65	76.1	160	8	10	8	10	26	38	110	3	M12	4	14	130	88	9	6	100
80	88.9	190	10	10	10	10	28	42	128	3	M16	4	18	150	102	10	8	110
100	114.3	210	10	10	10	10	34	45	148	3	M16	4	18	170	130	10	8	130
*125	139.7	240	13	12	13	12	39	48	178	3	M16	8	18	200	155	10	8	160
150	168.3	265	13	12	13	12	39	48	202	3	M16	8	18	225	184	12	10	185
*175	193.7	295	13	14	-	14	-	52	230	3	M16	8	18	255	210	12	10	-
200	219.1	320	13	14	-	14	-	55	258	3	M16	8	18	280	236	15	10	-
*225	244.5	345	16	16	-	16	-	58	285	3	M16	8	18	305	264	15	12	-
250	273.0	375	16	16	-	16	-	60	312	3	M16	12	18	335	290	15	12	-
300	323.9	440	20	20	-	20	-	62	365	4	M20	12	22	395	342	15	12	-
350	355.6	490	22	22	-	22	-	62	415	4	M20	12	22	445	385	15	12	-
400	406.4	540	22	22	-	22	-	65	465	4	M20	16	22	495	438	15	12	-
450	457.2	595	24	25	-	25	-	65	520	4	M20	16	22	550	492	15	12	-
500	508.0	645	24	25	-	25	-	68	570	4	M20	20	22	600	538	15	12	-
550	559.0	705	24	28	-	28	-	68	620	5	M24	20	26	655	590	16	12	-
600	609.6	755	24	30	-	30	-	70	670	5	M24	20	26	705	640	16	12	-

* Non-preferred size



S.A.B.S 1123 Flanges *cont'd...*

Nominal pressure 1000 kPa		1000/2 = Table 9 1000/3 = Table 10		1000/4 = Table 11 1000/8 = Table 13														
Nom. Size	Pipe O.D d ₁	Flange							Raised face		Bolting	Drilling			Neck			Boss d ₅
		D	b	b ₁	b ₂	b ₃	h	h ₁	d ₄	f		No.	d ₂	k	d ₃	h ₂	r	
10	17.2	90	8	10	8	10	14	35	40	2	M12	4	14	60	28	6	4	30
15	21.3	95	8	10	8	10	14	35	45	2	M12	4	14	65	32	6	4	35
20	26.9	105	8	10	8	10	16	38	58	2	M12	4	14	75	40	6	4	45
25	33.7	115	8	10	8	10	16	38	68	2	M12	4	14	85	46	6	4	52
32	42.4	140	10	10	10	10	20	40	78	2	M16	4	18	100	56	6	6	60
40	48.3	150	10	10	10	10	20	42	88	3	M16	4	18	110	64	7	6	70
50	60.3	165	12	10	10	12	20	45	102	3	M16	4	18	125	75	8	6	85
65	76.1	185	12	12	12	12	26	45	122	3	M16	4	18	145	90	10	6	105
80	88.9	200	14	12	12	14	26	50	138	3	M16	8	18	160	105	10	8	118
100	114.3	220	14	12	12	14	32	52	158	3	M16	8	18	180	131	12	8	140
*125	139.7	250	16	14	14	16	36	55	188	3	M16	8	18	210	156	12	8	168
150	168.3	285	18	16	16	18	38	55	212	3	M20	8	22	240	184	12	10	195
*175	193.7	315	18	16	-	18	-	60	242	3	M20	8	22	270	210	12	10	-
200	219.1	340	18	18	-	18	-	62	268	3	M20	8	22	295	235	16	10	-
*225	244.5	370	18	18	-	18	-	62	290	3	M20	8	22	325	265	16	10	-
250	273.0	395	20	20	-	20	-	68	320	3	M20	12	22	350	292	16	12	-
300	323.9	445	22	22	-	22	-	68	370	4	M20	12	22	400	344	16	12	-
350	355.6	505	26	25	-	25	-	68	430	4	M20	16	22	460	385	16	12	-
400	406.4	565	26	25	-	25	-	72	482	4	M24	16	26	515	400	16	12	-
450	457.2	615	28	30	-	30	-	72	532	4	M24	20	26	565	492	16	12	-
500	508.0	670	28	32	-	32	-	75	585	4	M24	20	26	620	542	16	12	-
550	559.0	730	28	35	-	35	-	80	635	5	M24	20	26	675	592	18	12	-
600	609.6	780	28	38	-	38	-	80	685	5	M24	20	26	725	642	18	12	-

* Non-preferred size



S.A.B.S 1123 Flanges *cont'd...*

Nominal pressure 1600 kPa		1600/2 = Table 14 1600/3 = Table 15		1600/4 = Table 16 1600/8 = Table 18														
Nom. Size	Pipe O.D d ₁	Flange							Raised face		Bolting	Drilling			Neck			Boss d ₅
		D	b	b ₁	b ₂	b ₃	h	h ₁	d ₄	f		No.	d ₂	k	d ₃	h ₂	r	
10	17.2	90	8	10	8	10	14	35	40	2	M12	4	14	60	28	6	4	30
15	21.3	95	8	10	8	10	14	35	45	2	M12	4	14	65	32	6	4	35
20	26.9	105	8	10	8	10	16	38	58	2	M12	4	14	75	40	6	4	45
25	33.7	115	8	10	8	10	16	38	68	2	M12	4	14	85	46	6	4	52
32	42.4	140	10	10	10	10	20	40	78	2	M16	4	18	100	56	6	6	60
40	48.3	150	10	10	10	10	20	42	88	3	M16	4	18	110	64	7	6	70
50	60.3	165	12	12	12	12	22	45	102	3	M16	4	18	125	75	8	6	85
65	76.1	185	12	12	12	12	26	45	122	3	M16	4	18	145	90	10	6	105
80	88.9	200	14	14	14	14	28	50	138	3	M16	8	18	160	105	10	8	118
100	114.3	220	14	14	14	14	34	52	158	3	M16	8	18	180	131	12	8	140
*125	139.7	250	16	16	16	16	38	55	188	3	M16	8	18	210	156	12	8	168
150	168.3	285	18	18	18	18	40	55	212	3	M20	8	22	240	184	12	10	195
*175	193.7	315	20	20	-	20	-	60	242	3	M20	8	22	270	210	12	10	-
200	219.1	340	22	22	-	22	-	62	268	3	M20	12	22	295	235	16	10	-
*225	244.5	370	24	22	-	22	-	66	294	3	M20	12	22	325	265	16	10	-
250	273.0	405	24	25	-	25	-	70	320	3	M24	12	26	355	292	16	12	-
300	323.9	460	28	28	-	28	-	78	378	4	M24	12	26	410	344	16	12	-
350	355.6	520	30	30	-	30	-	82	438	4	M24	16	26	470	390	16	12	-
400	406.4	580	32	35	-	35	-	85	490	4	M24	16	26	525	445	16	12	-
450	457.2	640	34	40	-	40	-	87	550	4	M24	20	26	585	496	16	12	-
500	508.0	715	34	40	-	40	-	90	610	4	M30	20	33	650	548	16	12	-
550	559.0	775	36	-	-	-	-	95	670	5	M30	20	33	710	600	18	12	-
600	609.6	840	36	50	-	-	-	95	725	5	M30	20	33	770	652	18	12	-

* Non-preferred size



S.A.B.S 1123 Flanges *cont'd...*

Nominal pressure 2500 kPa											2500/2 = Table 19 2500/3 = Table 20		2500/4 = Table 21 2500/8 = Table 23					
Nom. Size	Pipe O.D d ₁	Flange							Raised face		Bolting	Drilling			Neck			Boss d ₅
		D	b	b ₁	b ₂	b ₃	h	h ₁	d ₄	f		No.	d ₂	k	d ₃	h ₂	r	
10	17.2	90	12	12	10	12	16	35	40	2	M12	4	14	60	28	6	4	30
15	21.3	95	14	14	11	14	17	38	45	2	M12	4	14	65	32	6	4	35
20	26.9	105	14	14	11	14	19	40	58	2	M12	4	14	75	40	6	4	45
25	33.7	115	16	16	12	16	22	40	68	2	M12	4	14	85	46	6	4	52
32	42.4	140	18	18	14	18	26	42	78	2	M16	4	18	100	55	6	6	60
40	48.3	150	18	20	14	20	28	45	88	3	M16	4	18	110	64	7	6	70
50	60.3	165	20	20	17	20	31	48	102	3	M16	4	18	125	75	8	6	85
65	76.1	185	22	22	17	22	33	52	122	3	M16	8	18	145	90	10	6	105
80	88.9	200	24	22	18	22	34	58	138	3	M16	8	18	160	105	12	8	118
100	114.3	235	24	25	21	25	41	65	162	3	M20	8	22	190	134	12	8	145
*125	139.7	270	26	28	24	28	46	68	188	3	M24	8	26	220	162	12	8	170
150	168.3	300	28	30	24	30	48	75	218	3	M24	8	26	250	192	12	10	200
*175	193.7	330	30	30	-	25	-	75	248	3	M24	12	26	280	218	15	10	-
200	219.1	360	30	30	-	30	-	80	278	3	M24	12	26	310	244	16	10	-
*225	244.5	395	30	30	-	30	-	84	306	3	M24	12	26	340	270	16	10	-
250	273.0	425	30	30	-	30	-	88	335	3	M24	12	26	370	298	18	12	-
300	323.9	485	34	32	-	32	-	92	395	4	M24	16	26	430	352	18	12	-
350	355.6	555	38	35	-	35	-	100	450	4	M30	16	33	490	398	20	12	-
400	406.5	620	40	40	-	40	-	110	505	4	M30	16	33	550	452	20	12	-
450	457.2	670	42	45	-	45	-	110	555	4	M30	20	33	600	505	20	12	-
500	508.0	730	44	50	-	50	-	125	615	4	M30	20	33	660	558	20	12	-
550	559.0	785	-	55	-	-	-	-	670	5	M36	20	39	710	-	-	-	-
600	609.6	845	46	60	-	-	-	125	720	5	M36	20	39	770	660	20	12	-

* Non-preferred size



S.A.B.S 1123 Flanges *cont'd...*

Nominal pressure 4000 kPa		4000/2 = Table 24 4000/3 = Table 25				4000/4 = Table 26 4000/8 = Table 28												
Nom. Size	Pipe O.D d ₁	Flange							Raised face		Bolting	Drilling			Neck			Boss d ₅
		D	b	b ₁	b ₂	b ₃	h	h ₁	d ₄	f		No.	d ₂	k	d ₃	h ₂	r	
10	17.2	90	12	12	12	12	18	35	40	2	M12	4	14	60	28	6	4	30
15	21.3	95	14	14	14	14	20	38	45	2	M12	4	14	65	32	6	4	35
20	26.9	105	14	14	14	14	22	40	58	2	M12	4	14	75	40	6	4	45
25	33.7	115	16	16	16	16	26	40	68	2	M12	4	14	85	46	6	4	52
32	42.4	140	18	18	18	18	30	42	78	2	M16	4	18	100	55	6	6	60
40	48.3	150	18	20	18	20	32	45	88	3	M16	4	18	110	64	7	6	70
50	60.3	165	20	20	20	20	34	48	102	3	M16	4	18	125	75	8	6	85
65	76.1	185	22	22	22	22	38	52	122	3	M16	8	18	145	90	10	6	105
80	88.9	200	24	22	24	22	40	58	138	3	M16	8	18	160	105	12	8	118
100	114.3	235	24	25	24	25	44	65	162	3	M20	8	22	190	134	12	8	145
*125	139.7	270	26	28	26	28	48	68	188	3	M24	8	26	220	162	12	8	170
150	168.3	300	28	30	28	30	52	75	218	3	M24	8	26	250	192	12	10	200
*175	193.7	350	32	32	-	32	-	82	260	3	M24	12	26	295	218	15	10	-
200	219.1	375	34	32	-	32	-	88	285	3	M24	12	26	320	244	16	10	-
*225	244.5	420	36	35	-	35	-	100	315	3	M30	12	33	355	275	18	12	-
250	273.0	450	38	38	-	38	-	105	345	3	M30	12	33	385	306	18	12	-
300	323.9	515	42	40	-	40	-	115	410	4	M30	16	33	450	362	18	12	-
350	355.6	580	46	45	-	45	-	125	465	4	M30	16	33	510	408	20	12	-
400	406.4	660	50	50	-	50	-	135	535	4	M36	16	39	585	462	20	12	-
450	457.2	685	52	60	-	60	-	140	575	4	M36	20	39	610	510	20	12	-
500	508.0	755	52	70	-	70	-	140	615	4	M36	20	39	670	562	20	12	-
550	-	-	-	-	-	-	-	-	-	-	-	-	-	-	-	-	-	-
600	-	-	-	-	-	-	-	-	-	-	-	-	-	-	-	-	-	-

* Non-preferred size



STAINLESS STEEL FLANGES

ASA Specification - ANSI (ASA) B 16.5

150 lbs slip-on flanges and
welding neck flanges

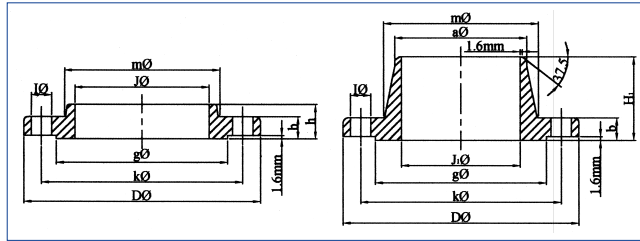

Pipe		Flange						Hub		Raised Face	Drilling Template		Approx. Weight ≈ Pounds S/O kilo W/N		
Nom. Size NW	O.D. in. mm	D in. mm	J in. mm	J ₁ in. mm	b in. mm	h in. mm	H ₁ in. mm	m in. mm	a in. mm	g in. mm	No.	I in. mm	k in. mm		
1/2"	0.84 21.3	3 1/2 88.9	0.88 22.3	0.62 15.7	7/16 11.1	5/8 15.9	1 7/8 47.6	1 3/16 30.2	0.84 21.3	1 3/8 34.9	4	5/8 15.9	2 3/8 60.3	1	2
3/4"	1.05 26.7	3 7/8 98.4	1.09 27.7	0.82 20.8	1/2 12.7	5/8 15.9	2 1/16 52.4	1 1/2 38.1	1.05 26.7	1 11/16 42.9	4	5/8 15.9	2 3/4 69.8	2	2
1"	1.315 33.4	4 1/4 107.9	1.36 34.5	1.05 26.7	9/16 14.3	11/16 17.5	2 3/16 55.6	1 15/16 49.2	1.32 33.5	2 50.8	4	5/8 15.9	3 1/8 79.4	2	3
1 1/4"	1.66 42.2	4 5/8 117.5	1.70 43.2	1.38 35.1	5/8 15.9	13/16 20.6	2 1/4 57.1	2 5/16 58.7	1.66 42.2	2 1/2 63.5	4	5/8 15.9	3 1/2 88.9	3	3
1 1/2"	1.90 48.3	5 127	1.95 49.5	1.61 40.9	11/16 17.5	7/8 22.2	2 7/16 61.9	2 9/16 65.1	1.90 48.3	2 7/8 73.0	4	5/8 15.9	3 7/8 98.4	3	4
2"	2.375 60.3	6 152.4	2.44 62.0	2.07 52.6	3/4 19.0	1 25.4	2 1/2 63.5	3 1/16 77.8	2.38 60.4	3 5/8 92.1	4	3/4 19.0	4 3/4 120.6	5	6
2 1/2"	2.875 73.0	7 177.8	2.94 74.7	2.47 62.7	7/8 22.2	1 1/8 28.6	2 3/4 69.8	3 9/16 90.5	2.88 73.1	4 1/8 104.8	4	3/4 19.0	5 1/2 139.7	7	8
3"	3.50 88.9	7 1/2 190.5	3.57 90.7	3.07 78.0	15/16 23.8	1 3/16 30.2	2 3/4 69.8	4 1/4 107.9	3.50 88.9	5 127	4	3/4 19.0	6 152.4	8	10
3 1/2"	4.00 101.6	8 1/2 215.9	4.07 103.4	3.55 90.2	15/16 23.8	1 1/4 31.7	2 13/16 71.4	4 13/16 122.2	4.00 101.6	5 1/2 139.7	8	3/4 19.0	7 177.8	11	12
4"	4.50 114.3	9 228.6	4.57 116.1	4.03 102.4	15/16 23.8	1 5/16 33.3	3 76.2	5 5/16 134.9	4.50 114.3	6 3/16 157.2	8	3/4 19.0	7 1/2 190.5	13	15
5"	5.563 141.3	10 254	5.66 143.8	5.05 128.3	15/16 23.8	1 7/16 36.5	3 1/2 88.9	6 7/16 163.5	5.56 141.2	7 5/16 185.7	8	7/8 22.2	8 1/2 215.9	15	19
6"	6.625 168.3	11 279.4	6.72 170.7	6.07 154.2	1 25.4	1 9/16 39.7	3 1/2 88.9	7 9/16 192.1	6.63 168.4	8 1/2 215.9	8	7/8 22.2	9 1/2 241.3	19	24
8"	8.625 219.1	13 1/2 342.9	8.72 221.5	7.98 202.7	1 1/8 28.6	1 3/4 44.4	4 101.6	9 11/16 246.1	8.63 219.2	10 5/8 269.9	8	7/8 22.2	11 3/4 298.4	30	39
10"	10.75 273	16 406.4	10.88 276.3	10.02 254.5	1 3/16 30.2	1 15/16 49.2	4 101.6	12 304.8	10.75 273	12 3/4 323.8	12	1 25.4	14 1/2 361.9	43	52
12"	12.75 323.8	19 482.6	12.88 327.1	12.00 304.8	1 1/4 31.7	2 3/16 55.6	4 1/2 114.3	14 3/8 365.1	12.75 323.8	15 381	12	1 25.4	17 431.8	64	80
14"	14.0 355.6	21 533.4	14.14 359.1		1 3/8 34.9	2 1/4 57.1	5 127	15 3/4 400	14.00 355.6	16 1/4 412.9	12	1 1/8 28.6	18 3/4 476.2	90	110
16"	16.0 406.4	23 1/2 596.9	16.16 410.5		1 7/16 36.5	2 1/2 63.5	5 127	18 457.2	16.00 406.4	18 1/2 469.9	16	1 1/8 28.6	21 1/4 539.7	98	140
18"	18.0 457.2	25 635	18.18 461.8		1 9/16 39.7	2 11/16 68.3	5 1/2 139.7	19 7/8 504.8	18.00 457.2	21 533.4	16	1 1/4 31.7	22 3/4 577.8	130	150
20"	20.0 508	27 1/2 698.5	20.20 513.1		1 11/16 42.9	2 7/8 73.0	5 11/16 144.5	22 558.8	20.00 508	23 584.2	20	1 1/4 31.7	25 635	165	180
24"	24.0 609.6	32 812.8	24.25 615.9		1 7/8 47.6	3 1/4 82.5	6 152.4	26 1/8 663.6	24.00 609.6	27 1/4 692.1	20	1 3/8 34.9	29 1/2 749.3	220	260
				To be specified by purchaser										99.8	118



STAINLESS STEEL FLANGES

ASA Specification - ANSI (ASA) B 16.5

300 lb slip-on flanges and welding neck flanges

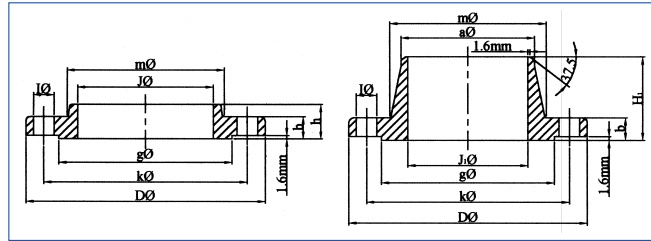

Pipe		Flange						Hub		Raised Face	Drilling Template			Approx. Weight	
Nom. Size NW	O.D. in. mm	D in. mm	J in. mm	J ₁ in. mm	b in. mm	h in. mm	H ₁ in. mm	a in. mm	m in. mm	g in. mm	No.	I in. mm	k in. mm	Pounds S/O kilo W/N	
1/2"	0.84 21.3	3 3/8 95.2	0.88 22.3	0.62 15.7	9/16 14.3	7/8 22.2	2 1/16 52.4	0.84 21.3	1 1/2 38.1	1 3/8 34.9	4	5/8 15.9	2 5/8 66.7	2 0.9	2 0.9
3/4"	1.05 26.7	4 5/8 117.5	1.09 27.7	0.82 20.8	5/8 15.9	1 25.4	2 1/4 57.1	1.05 26.7	1 7/8 47.6	1 11/16 42.9	4	3/4 19.0	3 1/4 82.5	3 1.4	3 1.4
1"	1.315 33.4	4 7/8 123.8	1.36 34.5	1.05 26.7	1 1/16 17.5	1 1/16 27.0	2 7/16 61.9	1.32 33.5	2 1/8 54.0	2 50.8	4	3/4 19.0	3 1/2 88.9	3 1.4	4 1.8
1 1/4"	1.66 42.2	5 1/4 133.3	1.70 43.2	1.38 35.1	3/4 19.0	1 1/16 27.0	2 9/16 65.1	1.66 42.2	2 1/2 63.5	2 1/2 63.5	4	3/4 19.0	3 7/8 98.4	4 1.8	5 2.3
1 1/2"	1.90 48.3	6 1/8 155.6	1.95 49.5	1.61 40.9	13/16 20.6	1 3/16 30.2	2 11/16 68.3	1.90 48.3	2 3/4 69.8	2 7/8 73.0	4	7/8 22.2	4 1/2 114.3	6 2.7	7 3.2
2"	2.375 60.3	6 1/2 165.1	2.44 62.0	2.07 52.6	7/8 22.2	1 5/16 33.3	2 3/4 69.8	2.38 60.4	3 5/16 84.1	3 5/8 92.1	8	3/4 19.0	5 127	7 3.2	9 4.1
2 1/2"	2.875 73.0	7 1/2 190.5	2.94 74.7	2.47 62.7	1 25.4	1 1/2 38.1	3 76.2	2.88 73.1	3 15/16 100	4 1/8 104.8	8	7/8 22.2	5 7/8 149.2	10 4.5	12 5.4
3"	3.50 88.9	8 3/4 209.5	3.57 90.7	3.07 78.0	1 1/8 28.6	1 11/16 42.9	3 1/8 79.4	3.50 88.9	4 5/8 117.5	5 127	8	7/8 22.2	6 5/8 168.3	13 5.9	15 6.8
3 1/2"	4.00 101.6	9 228.6	4.07 103.4	3.55 90.2	1 3/16 30.2	1 3/4 44.4	3 3/16 81.0	4.00 101.6	5 1/4 133.3	5 1/2 139.7	8	7/8 22.2	7 1/4 184.1	17 7.7	18 8.2
4"	4.50 114.3	10 254	4.57 116.1	4.03 102.4	1 1/4 31.7	1 7/8 47.6	3 3/8 85.7	4.50 114.3	5 3/4 146	6 3/16 157.2	8	7/8 22.2	7 7/8 200	22 10.0	25 11.3
5"	5.563 141.3	11 279.4	5.66 143.8	5.05 128.3	1 3/8 34.9	2 50.8	3 7/8 98.4	5.56 141.2	7 177.8	7 5/16 185.7	8	7/8 22.2	9 1/4 234.9	28 12.7	32 14.5
6"	6.625 168.3	12 1/2 317.5	6.72 170.7	6.07 154.2	1 7/16 36.5	2 1/16 52.4	3 7/8 98.4	6.63 168.4	8 1/8 206.4	8 1/2 215.9	12	7/8 22.2	10 5/8 269.9	39 17.7	42 19.0
8"	8.625 219.1	15 381	8.72 221.5	7.98 202.7	1 5/8 41.3	2 7/16 61.9	4 3/8 111.1	8.63 219.2	10 1/4 260.3	10 5/8 269.9	12	1 25.4	13 330.2	58 26.3	67 30.4
10"	10.75 273	17 1/2 444.5	10.88 276.3	10.02 254.5	1 7/8 47.6	2 5/8 66.7	4 5/8 117.5	10.75 273	12 5/8 320.7	12 3/4 323.8	16	1 1/8 28.6	15 1/4 387.3	81 36.7	91 41.3
12"	12.75 323.8	20 1/2 520.7	12.88 327.1	12.00 304.8	2 50.8	2 7/8 73	5 1/8 130.2	12.75 323.8	14 3/4 374.6	15 381	16	1 1/4 31.7	17 3/4 450.8	115 52.2	140 63.5
14"	14.0 355.6	23 584.2	14.14 359.1		2 1/8 54	3 76.2	5 5/8 142.9	14.00 355.6	16 3/4 425.4	16 1/4 412.7	20	1 1/4 31.7	20 1/4 514.3	165 74.8	180 81.6
16"	16.0 406.4	25 1/2 647.7	16.16 410.5		2 1/4 57.1	3 1/4 82.5	5 3/4 146	16.00 406.4	19 482.6	18 1/2 469.9	20	1 3/8 34.9	22 1/2 571.5	190 86.2	250 113
18"	18.0 457.2	28 711.2	18.18 461.8		2 3/8 60.3	3 1/2 88.9	6 1/4 158.7	18.00 457.2	21 533.4	21 533.4	24	1 3/8 34.9	24 3/4 628.6	250 113	320 145
20"	20.0 508	30 1/2 774.7	20.20 513.1		2 1/2 63.5	3 3/4 95.2	6 3/8 161.9	20.00 508	23 1/8 587.4	23 584.2	24	1 3/8 34.9	27 685.8	315 143	400 181
24"	24.0 609.6	36 914.4	24.25 615.9		2 3/4 69.8	4 3/16 106.4	6 5/8 168.3	24.00 609.6	27 5/8 701.7	27 1/4 692.1	24	1 5/8 41.3	32 812.8	475 215	580 263

To be specified by purchaser



STAINLESS STEEL FLANGES

BS 10/1962 - Dimensions, Mass and Maximum Pressure Ratings

Tables D and E

°C	-17.8 To 232.2	260	287.8	315.6	343.3	371.1	399	427	441	454	468	482	Max Hyd. Test Press
kPa													
'D'	689.7	655.2	586.2	551.7	482.8	448.3	379.3	344.85	-	-	-	-	1034.6
'E'	1379.4	1275.95	1172.5	1069	965.6	896.6	793.2	689.7	-	-	-	-	2069.5
Pipe		Diameter of Flange		Bolt Circle Diameter		Diameter of Bolts		Number of Bolts		Thickness of Flange		Approximate Weight in kilos	
Nom Size (in.)	OD (mm)	D	E	D	E	D	E	D	E	D	E	D	E
½	21.3	95.2	95.2	66.7	66.7	12	12	4	4	4.76	6.35	0.2	0.4
¾	26.9	101.6	101.6	73.0	73.0	12	12	4	4	4.76	6.35	0.2	0.5
1	33.7	114.3	114.3	82.6	82.6	12	12	4	4	4.76	7.14	0.5	0.6
1 ¼	42.2	120.6	120.6	87.3	87.3	12	12	4	4	6.35	7.94	0.6	0.8
1 ½	48.3	133.4	133.4	98.4	98.4	12	12	4	4	6.35	8.73	0.7	0.9
2	60.3	152.4	152.4	114.3	114.3	16	16	4	4	7.94	9.53	1.0	1.4
2 ½	76.1	165.1	165.1	127.0	127.0	16	16	4	4	7.94	10.32	1.1	1.6
3	88.9	184.2	184.2	146.0	146.0	16	16	4	4	9.53	11.1	1.6	1.8
3 ½	101.6	203.2	203.2	165.1	165.1	16	16	4	8	9.53	11.91	1.8	2.0
4	114.3	215.9	215.9	177.8	177.8	16	16	4	8	9.53	12.7	2.0	2.5
5	141.3	254.0	254.0	209.6	209.6	16	16	8	8	12.7	14.3	3.5	4.0
6	168.3	279.4	279.4	235.0	235.0	16	20	8	8	12.7	17.5	4.0	5.5
8	219.1	336.6	336.6	292.1	292.1	16	20	8	8	12.7	19.0	5.0	8.0
10	273	406.4	406.4	355.6	355.6	20	20	8	12	15.9	22.2	9.0	12.0
12	323.8	457.2	457.2	406.4	406.4	20	22	12	12	19.0	25.4	11.0	16.0
14	355.6	527.0	527.0	469.9	469.9	22	22	12	12	22.2	28.6	15.0	21.0
16	406.4	577.85	577.85	520.7	520.7	22	22	12	12	22.2	31.75	17.0	23.0
18	457.2	641.3	641.3	584.2	584.2	22	22	12	16	25.4	34.9	25.0	39.0
20	508	704.8	704.8	641.3	641.3	22	22	16	16	28.6	38.1	33.0	42.0
24	609.6	825.5	825.5	755.6	755.6	24	30	16	16	31.75	47.6	45.0	66.0



STAINLESS STEEL FLANGES

BS 10/1962 - Dimensions, Mass and Maximum Pressure Ratings

Tables F and H

°C	-17.8 To 232.2	260	287.8	315.6	343.3	371.1	399	427	441	454	468	482	Max Hyd. Test Press
kPa													
'F'	2069.1	1931.16	1758.74	1620.80	1482.86	1344.92	1172.49	1034.55	-	-	-	-	3103.65
'H'	3448.5	3207.1	2965.7	2724.3	2448.4	2207.0	1965.6	1724.2	1482.9	1241.5	1034.55	793.16	5172.75
Pipe	Diameter of Flange		Bolt Circle Diameter		Diameter of Bolts		Raised Face	Number of Bolts		Thickness of Flange		Approximate Weight in kilos	
Nom Size (in.)	F	H	F	H	F	H	H	F	H	F	H	F	H
½	95.2	114.3	66.7	82.6	12	16	57.15	4	4	9.53	12.7	0.5	0.7
¾	101.6	114.3	73.0	82.6	12	16	57.15	4	4	9.53	12.7	0.6	0.9
1	120.6	120.6	87.3	87.3	16	16	63.5	4	4	9.53	14.3	0.8	1.1
1 ¼	133.4	133.4	98.4	98.4	16	16	76.2	4	4	12.7	17.5	1.0	1.5
1 ½	139.7	139.7	104.8	104.8	16	16	82.6	4	4	12.7	17.5	1.4	1.8
2	165.1	165.1	127.0	127.0	16	16	101.6	4	4	15.9	19.0	2.3	2.5
2 ½	184.2	184.2	146.0	146.0	16	16	114.3	8	8	15.9	19.0	2.7	3.5
3	203.2	203.2	165.1	165.1	16	16	127.0	8	8	15.9	22.2	3.2	4.5
3 ½	215.9	215.9	177.8	177.8	16	16	139.7	8	8	19.0	22.2	4.0	5.5
4	228.6	228.6	190.5	190.5	16	16	152.4	8	8	19.0	25.4	4.5	6.0
5	279.4	279.4	235.0	235.0	20	20	177.8	8	8	22.2	28.6	8.0	10.0
6	304.8	304.8	260.4	260.4	20	20	209.6	12	12	22.2	28.6	8.5	11.0
8	368.3	368.3	323.8	323.8	20	20	260.4	12	12	25.4	31.8	13.5	17.0
10	431.8	431.8	381.0	381.0	22	22	311.2	12	12	28.6	34.9	18.0	24.5
12	489	489	438.2	438.2	22	22	362.0	16	16	31.8	41.3	24.0	31.0
14	552.5	552.5	495.3	495.3	24	24	419.1	16	16	34.9	47.6	31.0	
16	609.6	609.6	552.5	552.5	24	24	482.6	20	20	41.3	54.0	35.0	
18	673.1	673.1	609.6	609.6	30	30	533.4	20	20	44.5	60.3	41.0	
20	736.6	736.6	673.1	673.1	30	30	596.9	24	24	50.8	66.7		
24	850.9	850.9	781.0	781.0	30	30	698.5	24	24	57.15	76.2		



STAINLESS STEEL FLANGES

Flange Specification Comparisons

Nominal size 25

Table	Flange Diameter	P.C.D.	Hole Diameter	No. of Holes	Bolt Diameter	Raised Face d x h	Thickness (mm)				
							T1	T2	T3	T4	
BS 4504	6	100.0	75.0	11.0	4	M10	60.0 x 2.0	11.0	-	14.0	-
BS 4504	10	-	-	-	-	-	-	-	-	-	-
BS 4504	16	115.0	85.0	14.0	4	M12	68.0 x 2.0	16.0	8.0	16.0	-
BS 4504	25	115.0	85.0	14.0	4	M12	68.0 x 2.0	18.0	9.0	18.0	-
BS 4504	40	115.0	85.0	14.0	4	M12	68.0 x 2.0	-	11.0	18.0	18.0
BS 4504	64	-	-	-	-	-	-	-	-	-	-
BS 4504	100	140.0	100.0	18.0	4	M16	68.0 x 2.0	-	-	24.0	-
ASA 150		108.0	79.4	15.9	4	12.7	50.8 x 1.6	-	-	14.3	11.1
ASA 300		123.8	88.9	19.0	4	15.9	50.8 x 1.6	-	-	17.5	17.5
ASA 400		-	-	-	-	-	-	-	-	-	-
ASA 600		123.8	88.9	19.0	4	15.9	50.8 x 6.3	-	-	17.5	17.5
ASA 25		-	-	-	-	-	-	-	-	-	-
ASA 125		108.0	79.4	15.9	4	12.7	-	11.1	-	-	-
ASA 250		123.8	88.9	19.0	4	15.9	68.3 x 1.6	17.5	-	-	-
BS 10 D		114.3	82.6	14.3	4	12.7	-	12.7	7.9	12.7	12.7
BS 10 E		114.3	82.6	14.3	4	12.7	-	12.7	7.9	12.7	12.7
BS 10 F		120.6	87.3	17.5	4	15.9	-	12.7	9.5	12.7	12.7
BS 10 H		120.6	87.3	17.5	4	15.9	63.5 x 1.6	19.0	11.1	14.3	14.3
BS 10 J		120.6	87.3	17.5	4	15.9	63.5 x 1.6	-	19.0	19.0	19.0
BS 10 K		127.0	95.2	17.5	4	15.9	76.2 x 1.6	-	22.2	22.2	22.2
BS 10 R		127.0	95.2	17.5	4	15.9	76.2 x 1.6	-	-	22.2	22.2
SABS 1123											
5 (600/3)		100.0	75.0	11.0	4	M10	60.0 x 2.0	-	-	10.0	-
15 (1 600/3)		115.0	85.0	11.0	4	M12	68.0 x 2.0	-	-	10.0	-
25 (4 000/3)		115.0	85.0	14.0	4	M12	68.0 x 2.0	-	-	16.0	-

T1 = Cast iron

T2 = Copper alloy

T3 = Wrought steel

T4 = Cast steel



STAINLESS STEEL FLANGES

Flange Specification Comparisons

Nominal size 32

Table	Flange Diameter	P.C.D.	Hole Diameter	No. of Holes	Bolt Diameter	Raised Face d x h	Thickness (mm)			
							T1	T2	T3	T4
BS 4504	6	120.0	90.0	4	M12	70.0 x 2.0	16.0	-	14.0	-
BS 4504	10	-	-	-	-	-	-	-	-	-
BS 4504	16	140.0	100.0	4	M16	78.0 x 2.0	18.0	8.0	16.0	-
BS 4504	25	140.0	100.0	4	M16	78.0 x 2.0	20.0	9.0	18.0	-
BS 4504	40	140.0	100.0	4	M16	78.0 x 2.0	-	11.0	18.0	18.0
BS 4504	64	-	-	-	-	-	-	-	-	-
BS 4504	100	155.0	110.0	4	M20	78.0 x 2.0	-	-	24.0	-
ASA 150		117.5	88.9	4	12.7	63.5 x 1.6	-	10.3	15.9	12.7
ASA 300		133.4	98.4	4	15.9	63.5 x 1.6	-	15.9	19.0	19.0
ASA 400		-	-	-	-	-	-	-	-	-
ASA 600		133.4	98.4	4	15.9	63.5 x 6.3	-	-	20.6	20.6
ASA 25		-	-	-	-	-	-	-	-	-
ASA 125		117.5	88.9	4	12.7	-	12.7	-	-	-
ASA 250		133.4	98.4	4	15.9	77.8 x 1.6	19.0	-	-	-
BS 10 D		120.6	87.3	4	12.7	-	15.9	7.9	12.7	12.7
BS 10 E		120.6	87.3	4	12.7	-	15.9	7.9	12.7	12.7
BS 10 F		133.4	98.4	4	15.9	-	15.9	9.5	12.7	12.7
BS 10 H		133.4	98.4	4	15.9	76.2 x 1.6	22.2	11.1	17.5	17.5
BS 10 J		133.4	98.4	4	15.9	76.2 x 1.6	-	19.05	19.05	19.05
BS 10 K		133.4	98.4	4	15.9	76.2 x 1.6	-	22.2	22.2	22.2
BS 10 R		133.4	98.4	4	15.9	76.2 x 1.6	-	-	22.2	22.2
SABS 1123										
5 (600/3)		120.0	90.0	4	M12	70.0 x 2.0	-	-	10.0	-
15 (1 600/3)		140.0	100.0	4	M16	78.0 x 2.0	-	-	10.0	-
25 (4 000/3)		140.0	100.0	4	M16	78.0 x 2.0	-	-	18.0	-

T1 = Cast iron

T2 = Copper alloy

T3 = Wrought steel

T4 = Cast steel



STAINLESS STEEL FLANGES

Flange Specification Comparisons

Nominal size 40

Table	Flange Diameter	P.C.D.	Hole Diameter	No. of Holes	Bolt Diameter	Raised Face d x h	Thickness (mm)				
							T1	T2	T3	T4	
BS 4504	6	130.0	100.0	14.0	4	M12	80.0 x 3.0	16.0	-	14.0	-
BS 4504	10	-	-	-	-	-	-	-	-	-	-
BS 4504	16	150.0	110.0	18.0	4	M16	88.0 x 3.0	18.0	9.0	16.0	-
BS 4504	25	150.0	110.0	18.0	4	M16	88.0 x 3.0	13.0	11.0	18.0	-
BS 4504	40	150.0	110.0	18.0	4	M16	88.0 x 3.0	15.0	13.0	18.0	18.0
BS 4504	64	-	-	-	-	-	-	-	-	-	-
BS 4504	100	170.0	125.0	22.0	4	M20	88.0 x 3.0	-	-	26.0	-
ASA 150		127.0	98.4	15.9	4	12.7	73.0 x 1.6	-	14.3	17.5	14.3
ASA 300		155.6	114.3	22.2	4	19.0	73.0 x 1.6	-	17.5	20.6	20.6
ASA 400		-	-	-	-	-	-	-	-	-	-
ASA 600		155.6	114.3	22.2	4	19.0	73.0 x 1.6	-	-	22.2	22.2
ASA 25		-	-	-	-	-	-	-	-	-	-
ASA 125		127.0	98.4	15.9	4	12.7	-	14.3	-	-	-
ASA 250		155.6	114.3	22.2	4	19.0	90.5 x 1.6	20.6	-	-	-
BS 10 D		133.4	98.4	14.3	4	12.7	-	15.9	9.5	12.7	12.7
BS 10 E		133.4	98.4	14.3	4	12.7	-	15.9	9.5	12.7	12.7
BS 10 F		139.7	104.8	17.5	4	15.9	-	15.9	14.3	12.7	12.7
BS 10 H		139.7	104.8	17.5	4	15.9	82.6 x 1.6	22.2	12.7	17.5	17.5
BS 10 J		139.7	104.8	17.5	4	15.9	82.6 x 1.6	-	22.2	22.2	22.2
BS 10 K		152.4	114.3	22.2	4	19.0	88.9 x 1.6	-	25.4	25.4	25.4
BS 10 R		152.4	114.3	22.2	4	19.0	88.9 x 1.6	-	-	25.4	25.4
SABS 1123											
5 (600/3)		130.0	100.0	14.0	4	M12	80.0 x 3.0	-	-	10.0	-
15 (1 600/3)		150.0	110.0	18.0	4	M16	88.0 x 3.0	-	-	10.0	-
25 (4 000/3)		150.0	110.0	18.0	4	M16	88.0 x 3.0	-	-	20.0	-

T1 = Cast iron

T2 = Copper alloy

T3 = Wrought steel

T4 = Cast steel



STAINLESS STEEL FLANGES

Flange Specification Comparisons

Nominal size 50

Table	Flange Diameter	P.C.D.	Hole Diameter	No. of Holes	Bolt Diameter	Raised Face d x h	Thickness (mm)			
							T1	T2	T3	T4
BS 4504 6	140.0	110.0	14.0	4	M12	90.0 x 3.0	16.0	-	14.0	-
BS 4504 10	-	-	-	-	-	-	-	-	-	-
BS 4504 16	165.0	125.0	18.0	4	M16	102.0 x 3.0	20.0	11.0	18.0	-
BS 4504 25	165.0	125.0	18.0	4	M16	102.0 x 3.0	22.0	11.0	20.0	-
BS 4504 40	165.0	125.0	18.0	4	M16	102.0 x 3.0	-	13.0	20.0	20.0
BS 4504 64	180.0	135.0	22.0	4	M20	102.0 x 3.0	-	-	26.0	26.0
BS 4504 100	195.0	145.0	26.0	4	M24	-	-	-	28.0	-
ASA 150	152.4	120.6	19.0	4	15.9	92.0 x 1.6	-	12.7	19.0	15.9
ASA 300	165.1	127.0	19.0	8	15.9	92.0 x 1.6	-	19.0	22.2	22.2
ASA 400	-	-	-	-	-	-	-	-	-	-
ASA 600	165.1	127.0	19.0	8	15.9	92.0 x 6.3	-	-	25.4	25.4
ASA 25	-	-	-	-	-	-	-	-	-	-
ASA 125	152.4	120.6	19.0	4	15.9	-	15.9	-	-	-
ASA 250	165.1	127.0	19.0	8	15.9	106.4 x 1.6	22.2	-	-	-
BS 10 D	152.4	114.3	17.5	4	15.9	-	17.5	9.5	12.7	14.3
BS 10 E	152.4	114.3	17.5	4	15.9	-	19.0	9.5	12.7	14.3
BS 10 F	165.1	127.0	17.5	4	15.9	-	19.0	11.1	15.9	15.9
BS 10 H	165.1	127.0	17.5	4	15.9	101.6 x 1.6	25.4	12.7	19.0	19.0
BS 10 J	165.1	127.0	22.2	4	19.0	101.6 x 1.6	-	25.4	25.4	25.4
BS 10 K	165.1	127.0	17.5	8	15.9	101.6 x 1.6	-	25.4	25.4	25.4
BS 10 R	165.1	127.0	17.5	8	15.9	101.6 x 1.6	-	-	25.4	25.4
SABS 1123										
5 (600/3)	140.0	110.0	14.0	4	M12	90.0 x 3.0	-	-	10.0	-
15 (1 600/3)	165.0	125.0	18.0	4	M16	102.0 x 3.0	-	-	12.0	-
25 (4 000/3)	165.0	125.0	18.0	4	M16	102.0 x 3.0	-	-	20.0	-

T1 = Cast iron

T2 = Copper alloy

T3 = Wrought steel

T4 = Cast steel



STAINLESS STEEL FLANGES

Flange Specification Comparisons

Nominal size 65

Table	Flange Diameter	P.C.D.	Hole Diameter	No. of Holes	Bolt Diameter	Raised Face d x h	Thickness (mm)				
							T1	T2	T3	T4	
BS 4504	6	160.0	130.0	14.0	4	M12	110.0 x 3.0	16.0	-	14.0	-
BS 4504	10	-	-	-	-	-	-	-	-	-	-
BS 4504	16	185.0	145.0	18.0	4	M16	122.0 x 3.0	20.0	13.0	18.0	18.0
BS 4504	25	185.0	145.0	18.0	8	M16	122.0 x 3.0	24.0	13.0	22.0	-
BS 4504	40	185.0	145.0	18.0	8	M16	122.0 x 3.0	-	14.0	22.0	22.0
BS 4504	64	205.0	160.0	22.0	8	M20	122.0 x 3.0	-	-	26.0	26.0
BS 4504	100	220.0	170.0	26.0	8	M24	122.0 x 3.0	-	-	30.0	-
ASA 150		177.8	139.7	19.0	4	15.9	104.8 x 1.6	-	14.3	22.2	17.5
ASA 300		190.5	149.2	22.2	8	19.0	104.8 x 1.6	-	20.6	25.4	25.4
ASA 400		-	-	-	-	-	-	-	-	-	-
ASA 600		190.5	149.2	22.2	8	19.0	104.8 x 1.6	-	-	28.6	28.6
ASA 25		-	-	-	-	-	-	-	-	-	-
ASA 125		177.9	139.7	19.0	4	15.9	-	17.5	-	-	-
ASA 250		190.5	149.2	22.2	8	19.0	125.4 x 1.6	25.4	-	-	-
BS 10 D		165.1	127.0	17.5	4	15.9	-	17.5	11.1	12.7	14.3
BS 10 E		165.1	127.0	17.5	4	15.9	-	19.0	11.1	12.7	14.3
BS 10 F		184.2	146.0	17.5	8	15.9	-	19.0	12.7	15.9	15.9
BS 10 H		184.2	146.0	17.5	8	15.9	114.3 x 1.6	25.4	14.3	19.0	19.0
BS 10 J		184.2	146.0	22.2	8	19.0	114.3 x 1.6	-	25.4	25.4	25.4
BS 10 K		184.2	146.0	22.2	8	19.0	114.3 x 1.6	-	28.6	28.6	28.6
BS 10 R		184.2	146.0	22.2	8	19.0	114.3 x 1.6	-	-	28.6	28.6
SABS 1123											
5 (600/3)		160.0	130.0	14.0	4	M12	110.0 x 3.0	-	-	10.0	-
15 (1 600/3)		185.0	145.0	18.0	4	M16	122.0 x 3.0	-	-	12.0	-
25 (4 000/3)		185.0	145.0	18.0	8	M16	122.0 x 3.0	-	-	22.0	-

T1 = Cast iron

T2 = Copper alloy

T3 = Wrought steel

T4 = Cast steel



STAINLESS STEEL FLANGES

Flange Specification Comparisons

Nominal size 80

Table	Flange Diameter	P.C.D.	Hole Diameter	No. of Holes	Bolt Diameter	Raised Face d x h	Thickness (mm)				
							T1	T2	T3	T4	
BS 4504	6	190.0	150.0	18.0	4	M16	128.0 x 3.0	18.0	-	16.0	-
BS 4504	10	200.0	160.0	18.0	8	M16	138.0 x 3.0	-	-	20.0	-
BS 4504	16	200.0	160.0	18.0	8	M16	138.0 x 3.0	22.0	13.0	20.0	20.0
BS 4504	25	200.0	160.0	18.0	8	M16	138.0 x 3.0	26.0	14.0	24.0	-
BS 4504	40	200.0	160.0	18.0	8	M16	138.0 x 3.0	-	16.0	24.0	24.0
BS 4504	64	215.0	170.0	22.0	8	M20	138.0 x 3.0	-	-	28.0	28.0
BS 4504	100	230.0	180.0	26.0	8	M24	138.0 x 3.0	-	-	32.0	-
ASA 150		190.5	152.4	19.0	4	15.9	127.0 x 1.6	-	15.9	23.8	19.0
ASA 300		209.6	168.3	22.2	8	19.0	127.0 x 1.6	-	23.0	28.6	28.6
ASA 400		-	-	-	-	-	-	-	-	-	-
ASA 600		209.6	168.3	22.2	8	19.0	127.0 x 6.3	-	-	31.8	31.8
ASA 25		-	-	-	-	-	-	-	-	-	-
ASA 125		190.5	152.4	19.0	4	15.9	-	19.0	-	-	-
ASA 250		209.6	168.3	22.2	8	19.0	144.5 x 1.6	28.6	-	-	-
BS 10 D		184.2	146.0	17.5	4	15.9	-	19.0	12.7	12.7	14.3
BS 10 E		184.2	146.0	17.5	4	15.9	-	19.0	12.7	12.7	14.3
BS 10 F		203.2	165.1	17.5	8	15.9	-	19.0	14.3	15.9	15.9
BS 10 H		203.2	165.1	17.5	8	15.9	127.0 x 1.6	28.6	15.9	22.2	22.2
BS 10 J		203.2	165.1	22.2	8	19.0	127.0 x 1.6	-	31.8	31.8	31.8
BS 10 K		203.2	165.1	22.2	8	19.0	127.0 x 1.6	-	31.8	31.8	31.8
BS 10 R		203.2	165.1	22.2	8	19.0	127.0 x 1.6	-	-	31.8	31.8
SABS 1123											
5 (600/3)		190.0	150.0	18.0	4	M16	128.0 x 3.0	-	-	10.0	-
15 (1 600/3)		200.0	160.0	18.0	8	M16	138.0 x 3.0	-	-	14.0	-
25 (4 000/3)		200.0	160.0	18.0	8	M16	138.0 x 3.0	-	-	22.0	-

T1 = Cast iron

T2 = Copper alloy

T3 = Wrought steel

T4 = Cast steel



STAINLESS STEEL FLANGES

Flange Specification Comparisons

Nominal size 100

Table	Flange Diameter	P.C.D.	Hole Diameter	No. of Holes	Bolt Diameter	Raised Face d x h	Thickness (mm)				
							T1	T2	T3	T4	
BS 4504	6	210.0	170.0	18.0	4	M16	148.0 x 3.0	18.0	-	16.0	-
BS 4504	10	220.0	180.0	18.0	8	M16	158.0 x 3.0	-	-	20.0	-
BS 4504	16	220.0	180.0	18.0	8	M16	158.0 x 3.0	24.0	16.0	20.0	20.0
BS 4504	25	235.0	190.0	22.0	8	M20	162.0 x 3.0	28.0	17.0	24.0	-
BS 4504	40	235.0	190.0	22.0	8	M20	162.0 x 3.0	-	19.0	24.0	24.0
BS 4504	64	250.0	200.0	26.0	8	M24	162.0 x 3.0	-	-	30.0	30.0
BS 4504	100	265.0	210.0	30.0	8	M27	162.0 x 3.0	-	-	36.0	-
ASA 150		228.6	190.5	19.0	8	15.9	157.2 x 1.6	-	17.5	23.8	23.8
ASA 300		254.0	200.0	22.2	8	19.0	157.2 x 1.6	-	27.0	31.8	31.8
ASA 400		254.0	200.0	25.4	8	22.2	157.2 x 6.3	-	-	34.9	34.9
ASA 600		273.0	215.9	25.4	8	22.2	157.2 x 6.3	-	-	38.1	38.1
ASA 25		228.6	190.5	19.0	8	15.9	-	19.0	-	-	-
ASA 125		228.6	190.5	19.0	8	15.9	-	23.8	-	-	-
ASA 250		254.0	200.0	22.2	8	19.0	176.2 x 1.6	31.8	-	-	-
BS 10 D		215.9	177.8	17.5	4	15.9	-	19.0	15.9	12.7	17.5
BS 10 E		215.9	177.8	17.5	8	15.9	-	22.2	15.9	12.7	17.5
BS 10 F		228.6	190.5	17.5	8	15.9	-	22.2	17.5	19.0	19.0
BS 10 H		228.6	190.5	17.5	8	15.9	152.4 x 1.6	31.8	19.0	25.4	25.4
BS 10 J		228.6	190.5	22.2	8	19.0	152.4 x 1.6	-	34.9	34.9	34.9
BS 10 K		241.3	196.8	25.4	8	22.2	152.4 x 1.6	-	34.9	34.9	34.9
BS 10 R		241.3	196.8	25.4	8	22.2	152.4 x 1.6	-	-	34.9	34.9
SABS 1123											
5 (600/3)		210.0	170.0	18.0	4	M16	148.0 x 3.0	-	-	10.0	-
15 (1 600/3)		220.0	180.0	18.0	8	M16	158.0 x 3.0	-	-	14.0	-
25 (4 000/3)		235.0	190.0	22.0	8	M20	162.0 x 3.0	-	-	25.0	-

T1 = Cast iron

T2 = Copper alloy

T3 = Wrought steel

T4 = Cast steel



STAINLESS STEEL FLANGES

Flange Specification Comparisons

Nominal size 125

Table	Flange Diameter	P.C.D.	Hole Diameter	No. of Holes	Bolt Diameter	Raised Face d x h	Thickness (mm)				
							T1	T2	T3	T4	
BS 4504	6	240.0	200.0	18.0	8	M16	178.0 x 3.0	20.0	-	18.0	-
BS 4504	10	250.0	210.0	18.0	8	M16	188.0 x 3.0	-	-	22.0	-
BS 4504	16	250.0	210.0	18.0	8	M16	188.0 x 3.0	26.0	-	22.0	-
BS 4504	25	270.0	220.0	26.0	8	M24	188.0 x 3.0	30.0	-	26.0	-
BS 4504	40	270.0	220.0	26.0	8	M24	188.0 x 3.0	-	-	26.0	26.0
BS 4504	64	295.0	240.0	30.0	8	M27	188.0 x 3.0	-	-	34.0	34.0
BS 4504	100	315.0	250.0	33.0	8	M30	188.0 x 3.0	-	-	40.0	40.0
ASA 150		254.0	215.9	22.2	8	19.0	185.7 x 1.6	-	19.0	23.8	23.8
ASA 300		279.4	235.0	22.2	8	19.0	185.7 x 1.6	-	28.6	34.9	34.9
ASA 400		279.4	235.0	25.4	8	22.2	185.7 x 6.3	-	-	38.1	38.1
ASA 600		330.2	266.7	28.6	8	25.4	185.7 x 6.3	-	-	44.4	44.4
ASA 25		254.0	215.9	19.0	8	15.9	-	19.0	-	-	-
ASA 125		254.0	215.9	22.2	8	19.0	-	23.8	-	-	-
ASA 250		279.4	235.0	22.2	8	19.0	211.1 x 1.6	34.9	-	-	-
BS 10 D		254.0	209.6	17.5	8	15.9	-	20.6	17.5	12.7	17.5
BS 10 E		254.0	209.6	17.5	8	15.9	-	22.2	17.5	14.3	17.5
BS 10 F		279.4	235.0	22.2	8	19.0	-	25.4	19.0	22.2	22.2
BS 10 H		279.4	235.0	22.2	8	19.0	177.8 x 1.6	34.9	22.2	28.6	28.6
BS 10 J		279.4	235.0	25.4	8	22.2	177.8 x 1.6	-	38.1	38.1	38.1
BS 10 K		279.4	235.0	25.4	12	22.2	177.8 x 1.6	-	41.3	41.3	41.3
BS 10 R		279.4	235.0	25.4	12	22.2	177.8 x 1.6	-	-	41.3	41.3
SABS 1123											
5 (600/3)		240.0	200.0	18.0	8	M16	178.0 x 3.0	-	-	12.0	-
15 (1 600/3)		250.0	210.0	18.0	8	M16	188.0 x 3.0	-	-	16.0	-
25 (4 000/3)		270.0	220.0	26.0	8	M24	188.0 x 3.0	-	-	28.0	-

T1 = Cast iron

T2 = Copper alloy

T3 = Wrought steel

T4 = Cast steel



STAINLESS STEEL FLANGES

Flange Specification Comparisons

Nominal size 150

Table	Flange Diameter	P.C.D.	Hole Diameter	No. of Holes	Bolt Diameter	Raised Face d x h	Thickness (mm)				
							T1	T2	T3	T4	
BS 4504	6	265.0	225.0	18.0	8	M16	202.0 x 3.0	20.0	-	18.0	-
BS 4504	10	285.0	240.0	22.0	8	M20	212.0 x 3.0	-	-	22.0	-
BS 4504	16	285.0	240.0	22.0	8	M20	212.0 x 3.0	26.0	-	22.0	22.0
BS 4504	25	300.0	250.0	26.0	8	M24	218.0 x 3.0	34.0	-	28.0	-
BS 4504	40	300.0	250.0	26.0	8	M24	218.0 x 3.0	-	-	28.0	28.0
BS 4504	64	345.0	280.0	33.0	8	M30	218.0 x 3.0	-	-	36.0	36.0
BS 4504	100	355.0	290.0	33.0	12	M30	218.0 x 3.0	-	-	44.0	44.0
ASA 150		279.4	241.3	22.2	8	19.0	215.9 x 1.6	-	20.6	25.4	25.4
ASA 300		317.5	269.9	22.2	12	19.0	215.9 x 1.6	-	30.2	36.5	36.5
ASA 400		317.5	269.9	25.4	12	22.2	215.9 x 6.3	-	-	41.3	41.3
ASA 600		355.6	292.1	28.6	12	25.4	215.9 x 6.3	-	-	47.6	47.6
ASA 25		279.4	241.3	19.0	8	15.9	-	19.0	-	-	-
ASA 125		279.4	241.3	22.2	8	19.0	-	25.4	-	-	-
ASA 250		317.5	269.9	22.2	12	19.0	246.1 x 1.6	36.5	-	-	-
BS 10 D		279.4	235.0	17.5	8	15.9	-	20.6	17.5	12.7	17.5
BS 10 E		279.4	235.0	22.2	8	19.0	-	22.2	17.5	17.5	17.5
BS 10 F		304.8	260.4	22.2	12	19.0	-	25.4	22.2	22.2	22.2
BS 10 H		304.8	260.4	22.2	12	19.0	209.6 x 1.6	34.9	25.4	28.6	28.6
BS 10 J		304.8	260.4	25.4	12	22.2	209.6 x 1.6	-	38.1	38.1	38.1
BS 10 K		304.8	260.4	25.4	12	22.2	209.6 x 1.6	-	-	41.3	41.3
BS 10 R		304.8	260.4	25.4	12	22.2	209.6 x 1.6	-	-	44.4	44.4
SABS 1123											
5 (600/3)		265.0	225.0	18.0	8	M16	202.0 x 3.0	-	-	12.0	-
15 (1 600/3)		285.0	240.0	22.0	8	M20	212.0 x 3.0	-	-	18.0	-
25 (4 000/3)		300.0	250.0	26.0	8	M24	218.0 x 3.0	-	-	30.0	-

T1 = Cast iron

T2 = Copper alloy

T3 = Wrought steel

T4 = Cast steel



STAINLESS STEEL FLANGES

Flange Specification Comparisons

Nominal size 200

Table	Flange Diameter	P.C.D.	Hole Diameter	No. of Holes	Bolt Diameter	Raised Face d x h	Thickness (mm)				
							T1	T2	T3	T4	
BS 4504	6	320.0	280.0	18.0	8	M16	258.0 x 3.0	22.0	-	20.0	-
BS 4504	10	340.0	295.0	22.0	8	M20	268.0 x 3.0	26.0	-	24.0	-
BS 4504	16	340.0	295.0	22.0	12	M20	268.0 x 3.0	30.0	-	24.0	24.0
BS 4504	25	360.0	310.0	26.0	12	M24	278.0 x 3.0	34.0	-	30.0	30.0
BS 4504	40	375.0	320.0	30.0	12	M27	285.0 x 3.0	-	-	34.0	34.0
BS 4504	64	415.0	345.0	36.0	12	M33	285.0 x 3.0	-	-	42.0	42.0
BS 4504	100	430.0	360.0	36.0	12	M33	285.0 x 3.0	-	-	52.0	52.0
ASA 150		342.9	298.4	22.2	8	19.0	269.9 x 1.6	-	23.8	28.6	28.6
ASA 300		381.0	330.2	25.4	12	22.2	269.9 x 1.6	-	34.9	41.3	41.3
ASA 400		381.0	330.2	28.6	12	25.4	269.9 x 6.3	-	-	47.6	47.6
ASA 600		419.1	349.2	31.8	12	28.6	269.9 x 6.3	-	-	55.6	55.6
ASA 25		342.9	298.4	19.0	8	15.9	-	19.0	-	-	-
ASA 125		342.9	298.4	22.2	8	19.0	-	28.6	-	-	-
ASA 250		381.0	330.2	25.4	12	22.2	303.2 x 1.6	41.3	-	-	-
BS 10 D		336.6	292.1	17.5	8	15.9	-	22.2	19.0	12.7	19.0
BS 10 E		336.6	292.1	22.2	8	19.0	-	25.4	19.0	19.0	19.0
BS 10 F		368.3	323.8	22.2	12	19.0	-	28.6	25.4	25.4	25.4
BS 10 H		368.3	323.8	22.2	12	19.0	260.4 x 1.6	38.1	31.8	31.8	31.8
BS 10 J		368.3	323.8	25.4	12	22.2	260.4 x 1.6	-	41.3	41.3	41.3
BS 10 K		368.3	317.5	28.6	12	25.4	260.4 x 1.6	-	47.6	47.6	47.6
BS 10 R		368.3	323.8	28.6	12	25.4	260.4 x 1.6	-	-	50.8	50.8

T1 = Cast iron

T2 = Copper alloy

T3 = Wrought steel

T4 = Cast steel



STAINLESS STEEL FLANGES

Flange Specification Comparisons

Nominal size 250

Table	Flange Diameter	P.C.D.	Hole Diameter	No. of Holes	Bolt Diameter	Raised Face d x h	Thickness (mm)				
							T1	T2	T3	T4	
BS 4504	6	375.0	335.0	18.0	12	M16	312.0 x 3.0	24.0	-	22.0	-
BS 4504	10	395.0	350.0	22.0	12	M20	320.0 x 3.0	28.0	-	26.0	-
BS 4504	16	405.0	355.0	26.0	12	M24	320.0 x 3.0	32.0	-	26.0	26.0
BS 4504	25	425.0	370.0	30.0	12	M27	335.0 x 3.0	36.0	-	32.0	32.0
BS 4504	40	450.0	385.0	33.0	12	M30	345.0 x 3.0	-	-	38.0	38.0
BS 4504	64	470.0	400.0	36.0	12	M33	345.0 x 3.0	-	-	46.0	46.0
BS 4504	100	505.0	430.0	36.0	12	M36	345.0 x 3.0	-	-	60.0	60.0
ASA 150		406.4	362.0	25.4	12	22.2	323.8 x 1.6	-	-	30.2	30.2
ASA 300		444.5	387.4	28.6	16	25.4	323.8 x 1.6	-	-	47.6	47.6
ASA 400		444.5	387.4	31.8	16	28.6	323.8 x 6.3	-	-	54.0	54.0
ASA 600		508.0	431.8	34.9	16	31.8	323.8 x 6.3	-	-	63.5	63.5
ASA 25		406.4	362.0	19.0	12	15.9	-	22.2	-	-	-
ASA 125		406.4	362.0	25.4	12	22.2	-	30.2	-	-	-
ASA 250		444.5	387.4	28.6	16	25.4	357.2 x 1.6	47.6	-	-	-
BS 10 D		406.4	355.6	22.2	8	19.0	-	25.4	19.0	15.9	19.0
BS 10 E		406.4	355.6	22.2	12	19.0	-	25.4	22.2	22.2	22.2
BS 10 F		431.8	381.0	25.4	12	22.2	-	28.6	25.4	28.6	28.6
BS 10 H		431.8	381.0	25.4	12	22.2	311.2 x 1.6	41.3	34.9	34.9	34.9
BS 10 J		431.8	381.0	28.6	12	25.4	311.2 x 1.6	-	-	47.6	47.6
BS 10 K		431.8	381.0	28.6	16	25.4	311.2 x 1.6	-	-	50.8	50.8
BS 10 R		431.8	387.4	28.6	16	25.4	311.2 x 1.6	-	-	60.3	60.3

T1 = Cast iron

T2 = Copper alloy

T3 = Wrought steel

T4 = Cast steel



STAINLESS STEEL FLANGES

Flange Specification Comparisons

Nominal size 300

Table	Flange Diameter	P.C.D.	Hole Diameter	No. of Holes	Bolt Diameter	Raised Face d x h	Thickness (mm)				
							T1	T2	T3	T4	
BS 4504	6	440.0	395.0	22.0	12	M20	365.0 x 4.0	24.0	-	22.0	-
BS 4504	10	445.0	400.0	22.0	12	M20	370.0 x 4.0	28.0	-	26.0	-
BS 4504	16	460.0	410.0	26.0	12	M24	378.0 x 4.0	32.0	-	28.0	28.0
BS 4504	25	485.0	430.0	30.0	16	M27	395.0 x 4.0	40.0	-	34.0	34.0
BS 4504	40	515.0	450.0	33.0	16	M30	410.0 x 4.0	-	-	42.0	42.0
BS 4504	64	530.0	460.0	36.0	16	M33	410.0 x 4.0	-	-	52.0	52.0
BS 4504	100	585.0	500.0	42.0	16	M39	410.0 x 4.0	-	-	68.0	68.0
ASA 150		482.6	431.8	25.4	12	22.2	381.0 x 1.6	-	-	31.8	31.8
ASA 300		520.7	450.8	31.8	16	28.6	381.0 x 1.6	-	-	50.8	50.8
ASA 400		520.7	450.8	34.9	16	31.8	381.0 x 6.3	-	-	57.2	57.2
ASA 600		558.8	489.0	34.9	20	31.8	381.0 x 6.3	-	-	66.7	66.7
ASA 25		482.6	431.8	19.0	12	15.9	-	25.4	-	-	-
ASA 125		482.6	431.8	25.4	12	22.2	-	31.8	-	-	-
ASA 250		520.7	450.8	31.75	16	28.6	417.5 x 1.6	50.8	-	-	-
BS 10 D		457.2	406.4	22.2	12	19.0	-	25.4	22.2	19.0	22.2
BS 10 E		457.2	406.4	25.4	12	22.2	-	28.6	25.4	25.4	25.4
BS 10 F		489.0	438.2	25.4	16	22.2	-	31.8	28.6	31.8	31.8
BS 10 H		489.0	438.2	25.4	16	22.2	362.0 x 1.6	44.4	38.1	41.3	41.3
BS 10 J		489.0	438.2	28.6	16	25.4	362.0 x 1.6	-	-	50.8	50.8
BS 10 K		489.0	431.8	31.8	16	28.6	362.0 x 1.6	-	-	57.2	57.2
BS 10 R		508.0	457.2	31.8	16	28.6	362.0 x 1.6	-	-	69.8	69.8

T1 = Cast iron

T2 = Copper alloy

T3 = Wrought steel

T4 = Cast steel